

Well Owner's Information

Country/District/Municipality: Frontenac City/Town/Village: South Frontenac 23 Province: Ontario Postal Code: \_\_\_\_\_  
 UTM Coordinates: Zone: \_\_\_\_\_ Easting: \_\_\_\_\_ Northing: \_\_\_\_\_ Municipal Plan and Sublot Number: \_\_\_\_\_  
 NAD 83: 18S 842214921668

**Overburden and Bedrock Materials/Abandonment Sealing Record** (see instructions on the back of this form)

General Colour	Most Common Material	Other Materials	General Description	Depth (m/ft)	
				From	To
Brown	Fill			0	4
Red	GRANITE			4	72
Grey	GRANITE			72	99
Red	GRANITE			99	160

**Annular Space**

Depth Set at (m/ft)	Type of Sealant Used (Material and Type)	Volume Placed (m <sup>3</sup> /ft <sup>3</sup> )
20 0	CEMENT	8

**Results of Well Yield Testing**

After test of well yield, water was:	Draw Down		Recovery	
	Time (min)	Water Level (m/ft)	Time (min)	Water Level (m/ft)
<input checked="" type="checkbox"/> Clear and sand free <input type="checkbox"/> Other, specify	Static Level	8.4		
If pumping discontinued, give reason:	1	10.4	1	28.2
Pump intake set at (m/ft): <u>1.5ft</u>	2	10.7	2	26.4
Pumping rate (l/min / GPM): <u>56 G.P.M.</u>	3	11	3	24.9
Duration of pumping: <u>2 hrs + 0 min</u>	4	11.5	4	23
Final water level end of pumping (m/ft): <u>30.7</u>	5	11.9	5	21.8
(if flowing give rate (l/min / GPM))	10	17.1	10	16.2
Recommended pump depth (m/ft): <u>155</u>	15	20	15	12.9
Recommended pump rate (l/min / GPM): <u>56 G.P.M.</u>	20	22.4	20	10.4
Well production (l/min / GPM): <u>15+ G.P.M.</u>	25	24	25	9.6
Disinfected? <input checked="" type="checkbox"/> Yes <input type="checkbox"/> No	30	25.4	30	9.1
	40	27.6	40	8.6
	50	29	50	8.4
	60	30.7	60	8.4

**Method of Construction**

<input type="checkbox"/> Cable Tool	<input type="checkbox"/> Diamond	<input type="checkbox"/> Public	<input type="checkbox"/> Commercial	<input type="checkbox"/> Not used
<input type="checkbox"/> Rotary (Conventional)	<input type="checkbox"/> Jetting	<input checked="" type="checkbox"/> Domestic	<input type="checkbox"/> Municipal	<input type="checkbox"/> Dewatering
<input type="checkbox"/> Rotary (Reverser)	<input type="checkbox"/> Driving	<input type="checkbox"/> Livestock	<input type="checkbox"/> Test Hole	<input type="checkbox"/> Monitoring
<input type="checkbox"/> Boring	<input type="checkbox"/> Digging	<input type="checkbox"/> Irrigation	<input type="checkbox"/> Cooling & Air Conditioning	
<input checked="" type="checkbox"/> Air percussion		<input type="checkbox"/> Industrial		
<input type="checkbox"/> Other specify		<input type="checkbox"/> Other specify		

**Construction Record - Casing**

Inside Diameter (mm/in)	Open Hole OR Material (Galvanized, Fibreglass, Concrete, Plastic, Steel)	Wall Thickness (mm/in)	Depth (m/ft)		Status of Well
			From	To	
10 1/4"	STEEL	188	0	20	<input checked="" type="checkbox"/> Water Supply
6"	OPEN HOLE		20	160	<input type="checkbox"/> Replacement Well
					<input type="checkbox"/> Test Hole
					<input type="checkbox"/> Recharge Well
					<input type="checkbox"/> Dewatering Well
					<input type="checkbox"/> Observation/monitoring Hole
					<input type="checkbox"/> Alteration (Construction)
					<input type="checkbox"/> Abandoned
					<input type="checkbox"/> Insufficient Supply
					<input type="checkbox"/> Abandoned - Poor Water Quality
					<input type="checkbox"/> Abandoned - other, specify
					<input type="checkbox"/> Other specify

**Construction Record - Screen**

Outside Diameter (mm/in)	Material (Plastic, Galvanized Steel)	Slot No.	Depth (m/ft)		Status of Well
			From	To	
					<input type="checkbox"/> Abandoned - Poor Water Quality
					<input type="checkbox"/> Abandoned - other, specify
					<input type="checkbox"/> Other specify

**Water Details**

Water found at Depth (m/ft)	Kind of Water	Fresh	Untested
144 m/ft	Gas	Other specify	<input checked="" type="checkbox"/>

**Hole Diameter**

Depth (m/ft)	Diameter (mm/in)
0 - 20	10"
20 - 160	6"

**Well Contractor and Well Technician Information**

Business Name of Well Contractor: Jack Knox Well Drilling Ltd Well Contractor's License No: 3202  
 Business Address (Street Number/Name): 2580 Perth Rd Municipality: Glenburnie  
 Province: Ontario Postal Code: K0H1S0 Business E-mail Address: \_\_\_\_\_  
 Bus. Telephone No. (inc. area code): 613-5466164 Name of Well Technician (Last Name, First Name): Knox John  
 Well Technician's License No.: 2879 Signature of Technician and/or Contractor (Date Submitted): [Signature]

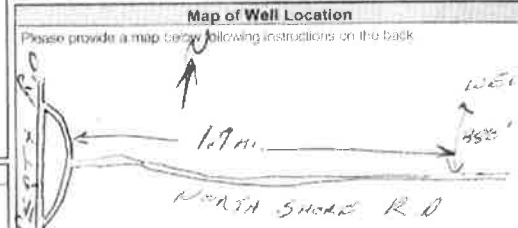

Comments: \_\_\_\_\_

Well owner's information package delivered: 20090707 Ministry Use Only: Audit No. Z 94402  
 Date Work Completed: 20090707 Date: JUL 29 2009  
 Yes/No: No