

OFFICE USE ONLY	Application # <u>1034-09</u>
Name: <u>RADEFORD</u>	Date Submitted: <u>Jun 22 2009</u>
Fee # <u>K-119-09</u>	Fee \$ <u>475.00</u>
Renewal Date:	H.U.G. <u>[Signature]</u>

1. New Dwelling Existing Dwelling

Total floor area: 1960 FT m² Number of bedrooms: 2 Bedrooms

2. Water Supply

Proposed Existing Dug or Bored Well Municipal Water Shore well Drilled well

Casing Depth: 22' Other: _____

3. Fixture Units for new or existing dwellings (see OBC Table 7.4.9.3 for non-residential)

	No.	Units
Bathroom group* (sink, toilet, and shower/tub combo)	<u>2</u>	<u>12</u>
Bathtub (with or without shower)	_____	x1.5 _____
Toilet	_____	x4 _____
Clothes Washer	<u>1</u>	x1.5 <u>1.5</u>
Dishwasher	_____	x .5 _____
Laundry Tubs	_____	x1.5 _____
Shower Drain	_____	x1.5 _____
Sinks	<u>1</u>	x1.5 <u>1.5</u>
Other	_____	x _____
Total Fixture Count	<u>15</u>	units

4. Soils

Subsurface Conditions Encountered

Rock & HGWT.	Depth (metres)	Soil Type
_____	0	_____
_____	.3	_____
_____	.6	_____
_____	.9	_____
_____	1.2	_____
_____	1.5	_____

Estimate Percolation Rate of Existing Soil:
_____ min/cm ≤ T ≤ _____ min/cm

Percolation Rate of Imported Soil:
_____ min/cm ≤ T ≤ _____ min/cm

5. Septic Tank Capacity:

Daily Design Sewage Flow (DDSF) 1660 l/per day

Septic or Holding tank (min. 3600L) (2xDDSF) 4500 litres

Standard Low Profile

6. Leaching Bed:

Conventional 240' m of pipe

Distribution pipe determined by using formula:

L = length of distribution pipe
Q = daily design sewage flow (box 5)
T = percolation rate of native or imported soil (box 4)

L = Q 1660 x 8 T
200

7. Filter Bed:

Loading Area _____ m² Contact Area A = $\frac{QT}{850}$

Length of Distribution Pipe _____ m Q _____ x _____ T

Contact Area = _____ m²

8. Tertiary Treatment:

Product Name: _____

BMEC Authorization No.: _____

Chamber System: _____

9. Loading Rate (See Table 8.7.4..A OBC):

Q _____ ÷ 10,8,6,4m²/day = N/A area (m²)

Directions to Property:

Division ST To North Shore Rd Lot on left

about 2 1/2 miles

(attach map if possible)

Recommendations/Conditions (for office use only):

Install a fully raised bed according to design and

Ontario Building Code

10-34-09

Schedule 2: Sewage System Installer Information

A. Project Information			
Building number, street name <i>North Shore Rd</i>		Lot <i>23</i>	Con. <i>7</i>
City/Town <i>Perth Road</i>	District <i>Lough</i>	Plan number/ other description	
B. Sewage system installer			
Is the installer of the sewage system engaged in the business of constructing on-site, installing, repairing, servicing, cleaning or emptying sewage systems, in accordance with Building Code Article 2.18.1.1?			
<input type="checkbox"/> Yes (Continue to Section C)		<input type="checkbox"/> No (Continue to Section E)	
		<input type="checkbox"/> Installer unknown at time of application (Continue to Section E)	
C. Registered installer information (where answer to B is "Yes")			
Name <i>W H Lee</i>		BCIN <i>16666</i>	
Street address <i>Parham</i>		Lot	Con.
City/Town	Postal code	Province <i>Ont</i>	E-mail
Telephone number <i>(613) 275 8848</i>	Fax ()	Cell number <i>(613) 583 8846</i>	
D. Qualified supervisor information (where answer to section B is "Yes")			
Name of qualified supervisor(s) <i>George Whaley</i>		Building Code Identification Number (BCIN) <i>11920</i>	
E. Declaration of Applicant:			
I <u><i>PAUL H. RADFORD</i></u> declare that:			
(print name)			
<input type="checkbox"/> I am the applicant for the permit to construct the sewage system. If the installer is unknown at time of application, I shall submit a new Schedule 2 prior to construction when the installer is known;			
<u>OR</u>			
<input type="checkbox"/> I am the holder of the permit to construct the sewage system, and am submitting a new Schedule 2 now that the installer is known.			
I certify that:			
1. The information contained in this schedule is true to the best of my knowledge.			
2. I have authority to bind the corporation or partnership (if applicable).			
<i>June 15 09</i>			
Date		Signature of applicant	

2034-09

G. Attachments

- i. Attach documents establishing compliance with applicable law as set out in Article 1.1.3.3.
- ii. Attach Schedule 1 for each individual who reviews and takes responsibility for design activities.
- iii. Attach Schedule 2 where application is to construct on-site, install or repair a sewage system.
- iv. Attach types and quantities of plans and specifications for the proposed construction or demolition that are prescribed by the by-law, resolution, or regulation of the municipality, upper-tier municipality, board of health or conservation authority to which this application is made.

H. Declaration of applicant

I Paul H. RAYFORD certify that:
 (print name)

1. The information contained in this application, attached schedules, attached plans and specifications, and other attached documentation is true to the best of my knowledge.
2. I have authority to bind the corporation or partnership (if applicable).

June 15 09 _____
 Date Signature of applicant

Personal information contained in this form and schedules is collected under the authority of subsection 8(1.1) of the *Building Code Act, 1992*, and will be used in the administration and enforcement of the *Building Code Act, 1992*. Questions about the collection of personal information may be addressed to: a) the Chief Building Official of the municipality or upper-tier municipality to which this application is being made, or, b) the inspector having the powers and duties of a chief building official in relation to sewage systems or plumbing for an upper-tier municipality, board of health or conservation authority to whom this application is made, or, c) Director, Building and Development Branch, Ministry of Municipal Affairs and Housing 777 Bay St., 2nd Floor. Toronto, M5G 2E5 (416) 585-6666.

APPLICATION NO: LO-34-09
 NAME: ADDFORD

12. **LOT DIAGRAM AND SEWAGE SYSTEM PLAN:** Drawing must be accurate, and to scale. Indicate north point and show:
- (a) Location of sewage system components (e.g. tanks, leaching bed). Locate and show horizontal distances from system to adjacent existing or proposed buildings, water supplies (including neighbours), existing on-site systems, driveways, property lines, lakes, rivers, springs, water courses, swimming pools
 - (b) Lot dimensions, topographic features (e.g. swamps, steep slopes) near system.
- 1 sq = 5 m/ft **DRAW TO SCALE**

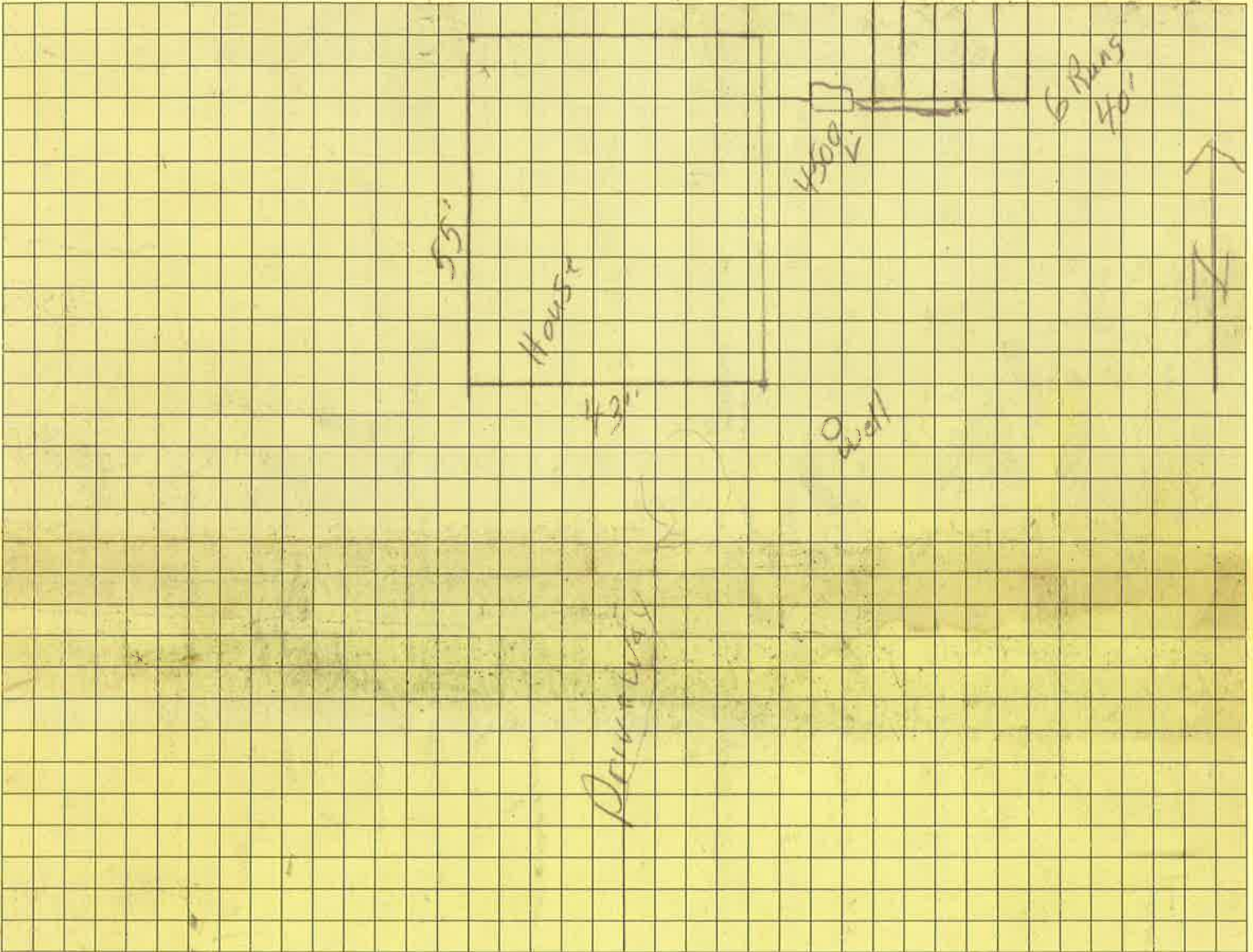

SEWAGE SYSTEM CROSS SECTION (FOR NEW SEWAGE SYSTEMS ONLY)

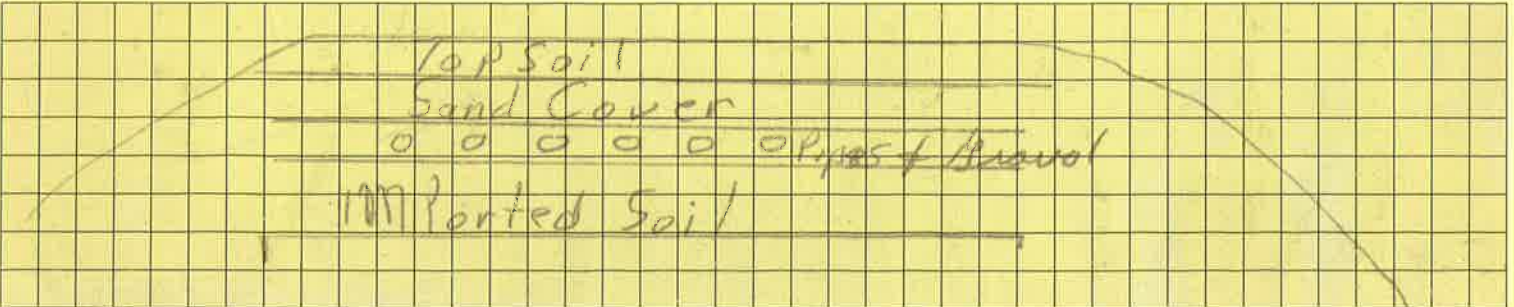

Benchmark:
 Approved Rejected (see recommendations on page 1)

Permit to install a Class 2,3,4 & 5 Sewage System under section 8-(1) (2) of the Building Code Act, S.O. 1992, C.23. This permit is issued to the owner to construct, install, alter, extend, enlarge or continue to use a Class 4 Sewage system.
 Any person who is not issued a permit may apply to the Building Code Commission for any issues involving the Building Code or Compliance to the Code.

Approved by Inspector D. Cede Date June 22/09
 7-70-27 (01/08)